

Service Manual

Stereo Integrated Amplifier

Amplifier

SU-V85A

Supplement

Color

(K) . . . Black Type

Color	Areas
(K)	[PA] . . . East PX.
(K)	[PE] . . . European Military.

Please use this manual together with the service manual for Model No. SU-V85A, Order No. HAD8612793C9.

CHANGES

■ SPECIFICATIONS

(OLD)

(NEW)

(DIN 45 500)

■ AMPLIFIER SECTION

20 Hz ~ 20 kHz continuous power output both channels driven	2 x 100W (8Ω)
1 kHz continuous power output both channels driven	2 x 150W (8Ω)
Total harmonic distortion rated power at 20 Hz ~ 20 kHz	0.002% (8Ω)
rated power at 1 kHz	0.0007% (8Ω)
Intermodulation distortion rated power at 250 Hz : 8 kHz = 4 : 1, 4Ω	0.005%
rated power at 60 Hz : 7 kHz = 4 : 1, SMPTE, 8Ω	0.005%
Power bandwidth both channels driven, -3 dB	5 Hz ~ 60 kHz (8Ω, 0.025%)
Load impedance MAIN or REMOTE	4Ω ~ 16Ω
MAIN and REMOTE	8Ω ~ 16Ω
Input sensitivity and impedance PHONO MM	2.5mV/47kΩ
PHONO MC	170μV/220Ω
TUNER, CD, AUX 1, AUX 2, TAPE 1/DA TAPE, TAPE 2, TAPE 3/EXT	150mV/18kΩ
PHONO maximum input voltage (1 kHz, RMS) MM	160mV
MC	12mV
S/N rated power PHONO MM	79 dB (88 dB, IHF, A)
PHONO MC	70 dB (72 dB, 250μV, IHF, A)
TUNER, CD, AUX 1, AUX 2, TAPE 1/DA TAPE, TAPE 2, TAPE 3/EXT	94 dB (IHF, A : 106 dB)

(IHF '78)

■ AMPLIFIER SECTION

Rated minimum sine wave RMS power output 20 Hz ~ 20 kHz both channels driven	120 W per channel (8Ω)
0.003% total harmonic distortion	
1 kHz continuous power output both channels driven	130 W per channel (8Ω)
0.003% total harmonic distortion	
Total harmonic distortion rated power at 20 Hz ~ 20 kHz	0.003% (8Ω)
rated power at 1 kHz	0.003% (8Ω)
Intermodulation distortion rated power at 250 Hz : 8 kHz = 4 : 1, 8Ω	0.005%
rated power at 50 Hz : 7 kHz = 4 : 1, SMPTE, 8Ω	0.005%
Power bandwidth both channels driven, -3 dB	5 Hz ~ 60 kHz (8Ω, 0.02%)
Load impedance MAIN or REMOTE	6Ω ~ 16Ω
MAIN and REMOTE	12Ω ~ 16Ω
Input sensitivity and impedance PHONO MM	0.25 mV (2.5 mV, IHF '66)/47 kΩ
PHONO MC	17μV (170μV, IHF '66)/220Ω
TUNER, CD, AUX 1, AUX 2, TAPE 1/DA TAPE, TAPE 2, TAPE 3/EXT	15 mV (150 mV, IHF '66)/18 kΩ
PHONO maximum input voltage MM	150 mV
MC	10 mV
S/N (IHF, A) PHONO MM	77 dB (88 dB, IHF '66)
PHONO MC	75 dB (72 dB, IHF '66)
TUNER, CD, AUX 1, AUX 2, TAPE 1/DA TAPE, TAPE 2, TAPE 3/EXT	82 dB (106 dB, IHF '66)

Technics

Matsushita Electric Trading Co., Ltd.
P. O. Box 288, Central Osaka Japan

Panasonic Tokyo Office
Matsushita Electric Trading Co., Ltd.
6th Floor, World Trade Center Bldg.
No. 4-1, Hamamatsu-cho 2-Chome, Minato-ku,
Tokyo 105, Japan

REPLACEMENT PARTS LIST

Ref. No.	Change of Part No.		Part Name & Description	Per Set (Pcs.)	Remarks
	OLD	NEW			
TRANSFORMER					
T1	Δ SLT5Q148	SLT5Q149	Power Transformer	1	Change
CABINET AND CHASSIS					
28	SMN2039	-----	Bracket	0	Deletion
38	SGP6940-4A	SGP6940-4B	Rear Panel	1	Change
CAPACITOR					
C601	Δ ECET71R103Y	ECET71R562U	Electrolytic, 71V, 5600μF	1	Change
C602	Δ ECET71R103Y	ECET71R562U	Electrolytic, 71V, 5600μF	1	Change
C603	Δ -----	ECET71R562U	Electrolytic, 71V, 5600μF*	1	Addition
C604	Δ -----	ECET71R562U	Electrolytic, 71V, 5600μF	1	Addition

SCHEMATIC DIAGRAM

(OLD)

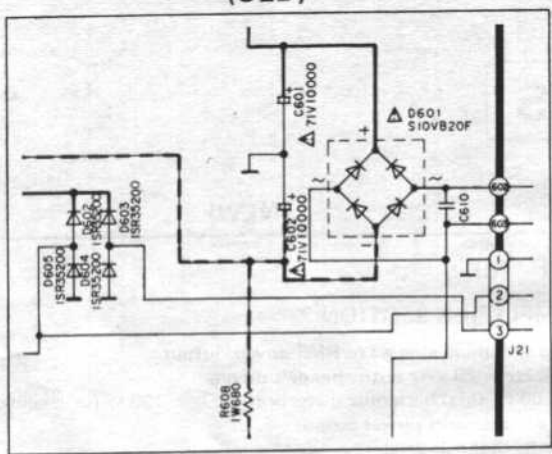

(NEW)

